

**A**  
SIZE

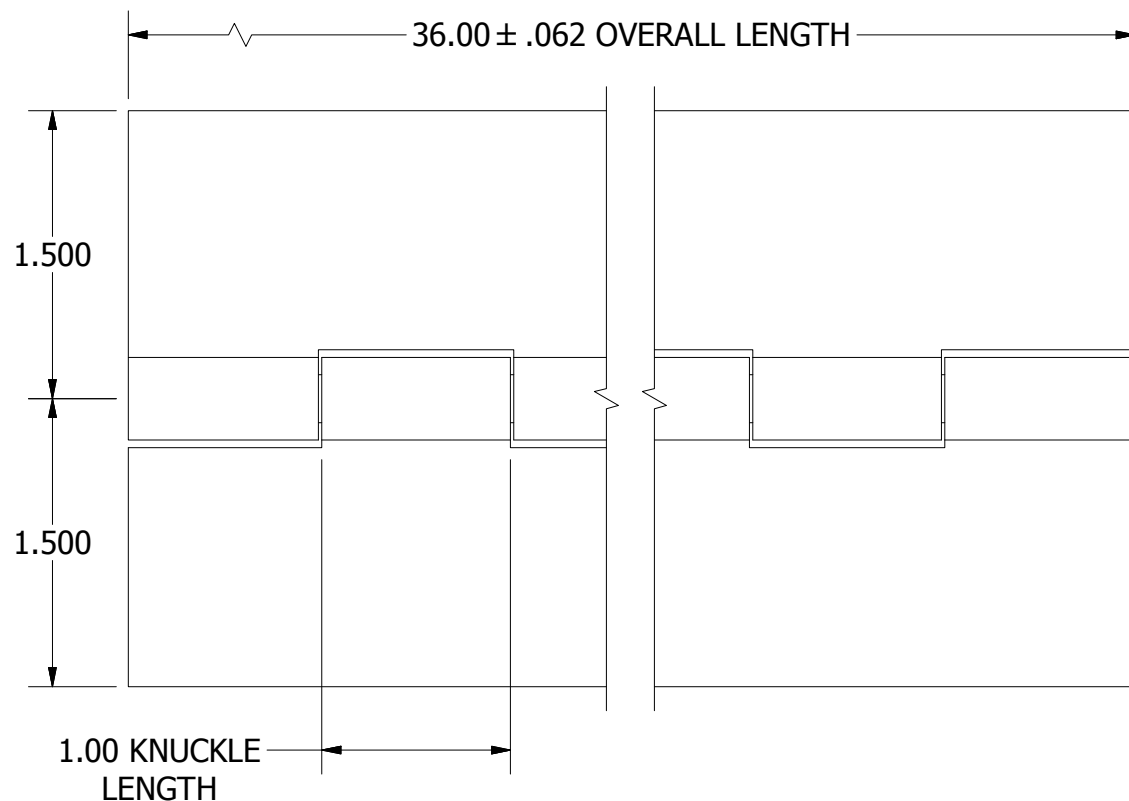

BEFORE OFFSET

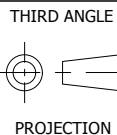
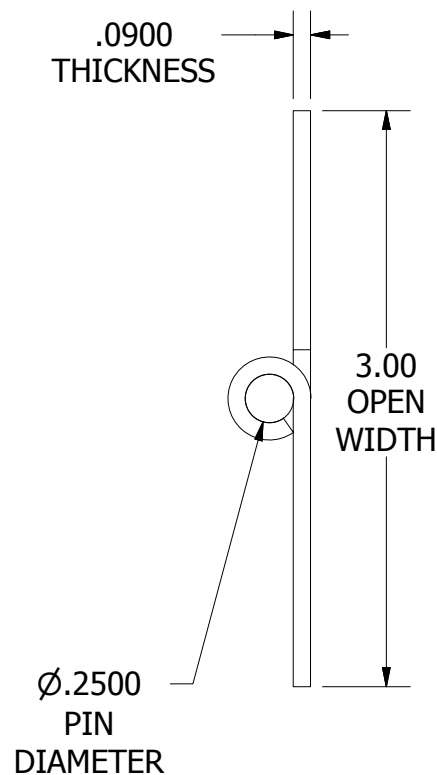

BEFORE OFFSET

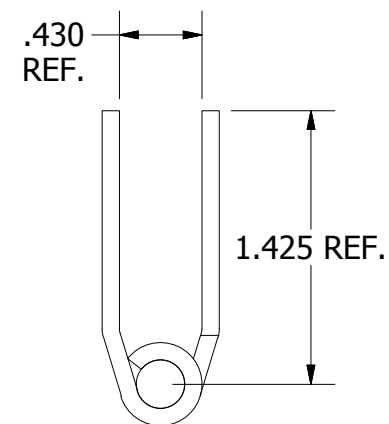

AFTER OFFSET  
(CLOSED POSITION)

**NOTES:**

- 1.) HINGE DRAWN KNUCKLE UP.
- 2.) ALL HINGES ARE COMMERCIAL DIE CUT QUALITY.
- 3.) RANGE OF MOTION IS APPROXIMATELY 270°.
- 4.) DIMENSIONS AND TOLERANCES APPLY TO PART PRIOR TO ANY FINISH APPLICATION.
- 5.) BOTH LEAVES OFFSET. OFFSETTING SLIGHTLY DECREASES LEAF WIDTH.

PART NUMBER:			SCALE:
SS093048360F			1:1
LEAF MATERIAL:	PIN MATERIAL:	FINISH:	
TYPE 304	TYPE 304	2B	
STAINLESS STEEL	STAINLESS STEEL		
MARLBORO STANDARD TOLERANCES UNLESS OTHERWISE SPECIFIED (ALL TOLERANCES ARE NON-CUMULATIVE)			
.X ± .060	.XXX ± .015	FRACTIONAL: 1/16	
.XX ± .030	.XXXX ± .005	ANGULAR: 1°	

**Marlboro**  
MANUFACTURING INC.

11750 Marlboro Avenue, NE  
Alliance, Ohio 44601  
www.marlbوروhinge.com  
sales@marlbوروhinge.com  
Phone 330-935-2445  
Fax 330-935-2748